

NOTES:

- 1) THIS TABLE REPRESENTS THE THEORETICAL TORQUE AT WHICH THE DIES WILL SLIP ON THE TUBULAR
- 2) THIS UNIT REQUIRES AND RP5047-7XXX MODEL CONTROL CONSOLE TO OPERATE
- 3) THE CLAMP CYLINDERS ARE RATED FOR 2,000 PSI, HOWEVER THE USER SHOULD NOT EXCEED THE TORQUE VALUES LISTED ON THE TABLE.

ITEM	Qty.	P/N	DESCRIPTION
1	1	200-7000-22A	ASSEMBLY, VISE, TONG
2	1	3000-7000	ASSEMBLY, GUARD, TONG
3	1	300-7022-01	ASSEMBLY, BACKUP, 22-105K
4	1	500-7022-12	ASSEMBLY, SKID, 12 FEET
5	2	CB11001-01-S5	PLATE, MOUNT
6	1	KITBOLT-49	BOLT KIT
7	1	KITBRG-46	BEARING KIT
8	1	KITFIT-47	FITTING KIT

BUCKING UNIT SPECIFICATIONS		
MAX TORQUE	105,000 ft-lbs	142,000 N-m
SYSTEM PRESSURE	3,000 PSI	207 Bar
ARM LENGTH	36 Inches	91cm
MASS	18,400 Lbs.	8,300 kg
SPEED (RPM, ESTIMATED)		
AT FLOW RATE (GPM/LPM):	26.4 GPM	100 LPM
LOW GEAR	2.7 RPM	
HIGH GEAR	7.7 RPM	

NUMBER OF JAWS	PIPE SIZE (IN)	MAX. TORQUE @ 1,000 PSI (ft-lb)
6 JAWS	9.625 - 21.500	105,000
	8.875	99,300
	7.625	85,300
	7.000	78,300

REVISIONS					
REVISION	ECN NUMBER	ECN DESCRIPTION	ECN COMPLETED BY	ECN COMPLETED DATE	
A	17-0111	UPDATED GA FORMAT TO NEW TEMPLATE	J. KELLY	2017	
UNLESS OTHERWISE SPECIFIED:		PROPRIETARY STATEMENT	DESCRIPTION		
1. DIMENSIONS ARE IN INCHES		THIS DOCUMENT IS THE PROPERTY OF MCCOY CORPORATION AND IS CONSIDERED CONFIDENTIAL. THIS INFORMATION MAY NOT BE USED, DISCLOSED, COPIED, OR REPRODUCED IN ANY FORM, WITHOUT THE EXPRESS WRITTEN CONSENT OF MCCOY CORPORATION	ASSEMBLY, BUCKING UNIT, 22-105K, 12 FT		
2. TOLERANCES:					
ANGULAR ± 1°					
FRACTIONAL ± 1/16			DRAWN	BARRETT	12/14/2009
TWO PLACE DECIMAL ± 0.02					
THREE PLACE DECIMAL ± 0.005			CHECKED	RM	SIZE B
3. IDENTIFY P/N & MATL. P.O. USING 1/8 TO 1/4 ETCHED LETTERS; DEVOTED BY "X"					
4. REMOVE BURRS & SHARP EDGES WITH 1/64x45° MAX			APPROVED	MG	PART NO.
5. MACHINED FILET RADII SHALL BE 1/32					
6. FINAL SURFACE ROUGHNESS AVG. (Ra) SHALL BE ≤ 250 MICROINCHES			THIRD ANGLE PROJECTION	WEIGHT	MATERIAL
7. ○ DENOTES CRITICAL DIMENSION; 100% INSPECTION REQUIRED					
8. A TRIANGLE DENOTES A REVISION			18415.796 LBS.	N/A	REV A
9. INTERPRET DRAWING PER ASME Y14.5-2009					

RELEASED FOR PRODUCTION

# STANDARD ACCESSORIES

HYDRAULIC SUPPORT STAND

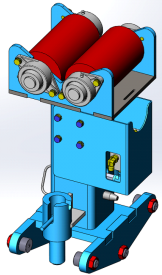

HYDRAULIC POWERED V-ROLLER  
SUPPORT STAND

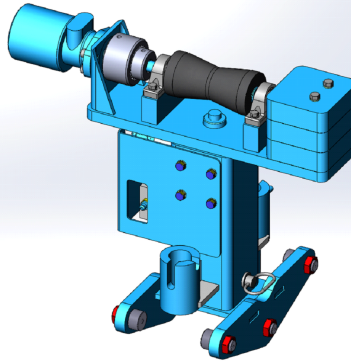

HYDRAULIC NON-POWERED V-ROLLER  
SUPPORT STAND

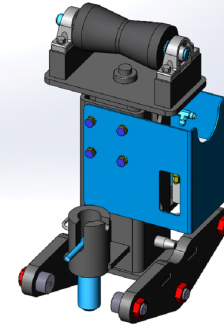

HYDRAULIC TRANSFER BALL ROLLER  
SUPPORT STAND

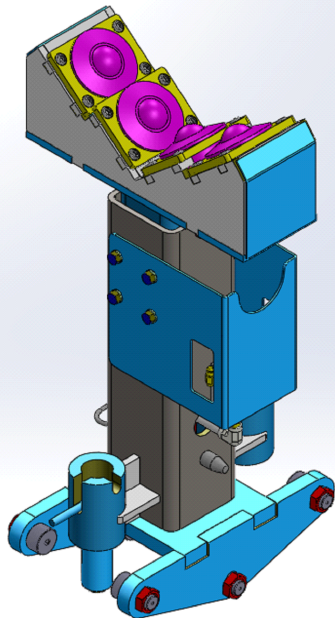

PUSH PULL

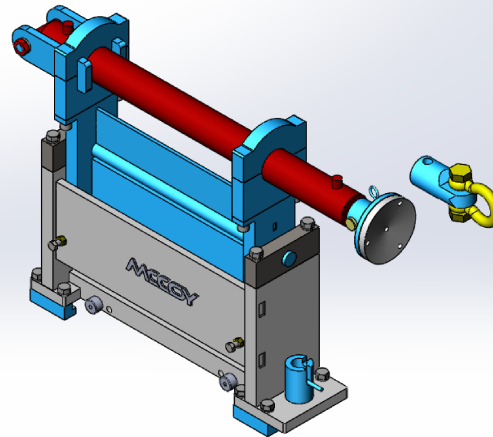

EXTENSION BEAM  
(AVAILABLE FROM 6' TO 20')

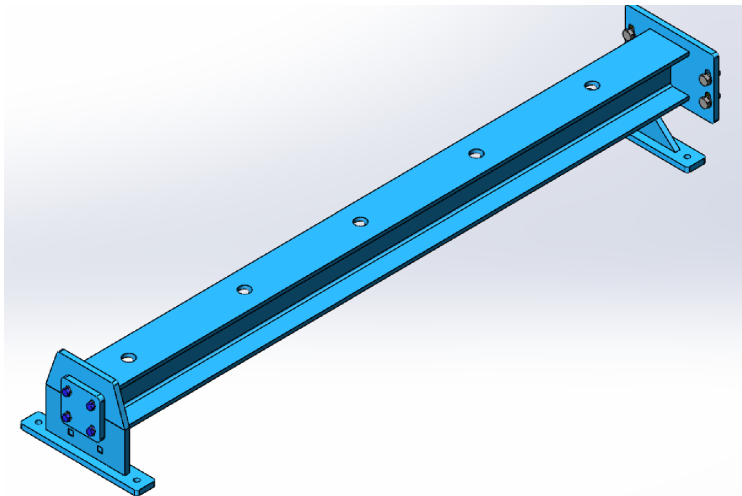

DESCRIPTION			
ASSEMBLY, BUCKING UNIT, 22-105K, 12 FT			
SIZE	PART NO.	REV	
A	RP7022	A	
MATERIAL		N/A	SHEET 2 OF 2